



FIRST-YEAR STUDENT TO-DO LIST



GETTING STARTED

- 5-15 mins
- 30 mins
- 1 hour

TASKS

- Retrieve NetID and password
- Set-up DUO authentication
- Log into and begin regularly checking Emory email
- Download the Emory Welcome App
- Update personal and family contact information in OPUS
- Review and plan to meet Immunization Requirements
- Review To-Do List Terms, Logins, and Forms

TIME WHERE TO COMPLETE

- it.emory.edu/acm/getpassword.cfm
- duo.emory.edu
- email.emory.edu > use NetID & password
- college.emory.edu/orientation/first-year/getting-started.html
- opus.emory.edu > Profile Tile
- studenthealth.emory.edu/immunization/
- [Student info here](#) + [Family info here](#)

MAY TO-DO LIST

COMPLETE BY JUNE 1

TASKS

- Submit EmoryCard Photo
- Submit Housing Application and select Dining Plan
- Submit Housing Accommodations request (if appl.)
- Complete FERPA Parental Consent Form (avail. May 8)
- Register for Pre-Orientation (avail. May 8)
- Review Renters Insurance (optional)
- Update Designated Name and Pronouns (optional)
- Update Student Characteristics (optional)
- Complete I-20 Request (F-1 visa holders)

TIME WHERE TO COMPLETE

- tinyurl.com/emorycard
- myhousing.emory.edu/
- accessibility.emory.edu/students/new-to-das
- http://tinyurl.com/ParentalConsentFERPA
- tinyurl.com/EmoryPre0
- myhousing.emory.edu/
- opus.emory.edu > Profile Tile
- opus.emory.edu > Profile Tile
- tinyurl.com/I20ISSSRequest

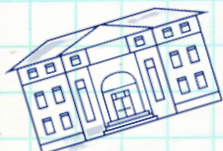
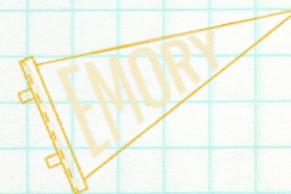

JUNE TO-DO LIST

COMPLETE BY JULY 1

TASKS

- Complete Health Forms and submit Immunizations
- Complete Student Profile (avail. June 1)
- Sign up for Pre-Registration Advising Appointment
- Submit Academic Accommodations requests (if appl.)
- Add parent/sponsor as Bill Payer in OPUS (if appl.)
- RSVP for International Student Welcome (F-1 visa holders)

TIME WHERE TO COMPLETE

- www.shspnc.emory.edu
- opus.emory.edu > Tasks > To-Do's
- Link will be sent to your email on June 26
- accessibility.emory.edu/students/new-to-das
- opus.emory.edu > Student Account Tile
- http://tinyurl.com/ISWEmory (avail. May 15)



FIRST-YEAR STUDENT TO-DO LIST

JULY TO-DO LIST

COMPLETE BY AUGUST 1

- 5-15 mins
- 30 mins
- 1 hour

TASKS

- Attend Pre-Registration Advising appointment
- Complete the *You Belong* Module (avail. July 1)
- Update Photo & NameCoach in Canvas
- Submit final high school transcript
- Submit AP/IB scores (if appl.)
- Submit previous college transcripts (if appl.)
- Create Guest Access in OPUS (avail. June 15)
- Set up Handshake account & choose Industry Cluster
- Sign Student Financial Agreement
- Review Tuition Insurance (optional)
- Complete COFHE New Student Survey (avail. July 15-Aug 15)
- Submit Student Health Insurance Waiver** (if appl.)
- Enroll in Direct Deposit (*F-1 visa holders may complete on campus during ISW*)

TIME

-
-
-
-
-
-
-
-
-
-
-
-
-

WHERE TO COMPLETE

- Zoom link will be sent to your email
- canvas.emory.edu
- canvas.emory.edu > Account > Profile
- apply.emory.edu/status
- admission.processing@emory.edu Info: tinyurl.com/APCred
- tinyurl.com/ApplicationItems
- opus.emory.edu > Guest Access
- emory.joinhandshake.com > Complete Prompts
- opus.emory.edu > Tasks > To-Do's
- opus.emory.edu > Student Account > Other Account Services
- opus.emory.edu > Tasks > To-Do's
- opus.emory.edu > Health Tile**
- opus.emory.edu > Student Account Tile

**Students without an approved opt-out waiver on file will be billed for the Emory Student Health Insurance Plan



AUGUST TO-DO LIST

DUE DATE

TASKS

- AUG 13-15 Register for classes
- AUG 24 Complete SAP-U
- AUG 24 Complete AlcoholEdu
- AUG 24 Complete ISSS Arrival Confirmation Form (F-1 visa)
- Aug 31 Register to vote

TIME

-
-
-
-
-
-

WHERE TO COMPLETE

- opus.emory.edu > Course Planning and Enrollment Tile
- Link will be sent to your email on August 5
- Link will be sent to your email on August 5
- isslink.emory.edu
- emory.turbovote.org



OTHER IMPORTANT DATES

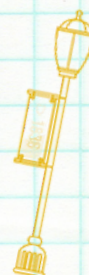

- JUL 8-9** Attend [Specialized Advising Webinars](#)
- JUL 9** Shopping Cart opens
- JUL 15** Housing assignments released
- JUL 15** Tuition and other charges posted on student account
- AUG 1** Begin shipping belongings to campus
- AUG TBD** Attend [Career Community Webinars](#)

- AUG 19** Move-in Day 1: Pre-Orientation & ISW begin
- AUG 24** Move-in Day 2: Orientation Week begins
- AUG 27** Add/Drop/Swap opens
- AUG 28** First day of classes
- AUG 30** Student Employment Fair
- SEPT 4** Fall payment due